



www.everythingid.com.au



LTE-400

WiFi & Cellular Smart Home Alarm System

User Manual

Foreword

Thank you for purchasing the alarm system. Please unpack the product, familiarize yourself with the component parts, and carefully read through the instruction guide before installation.

The installation must be completed in the order shown in the guide to ensure a successful installation.

Disclaimer

All statements, technical information and recommendations in this manual are believed to be reliable, but the accuracy and completeness thereof are not guaranteed or warranted.

The specifications and information regarding the products as shown in this document is subject to change without notice.

The reproduction, language translation modification, storage in a retrieval system or re-transmission, in any form or by any means, electronic, mechanical or otherwise, is strictly prohibited without prior written permission.

In no event are we liable for any indirect, special, incidental, or consequential damages, including, without limitation, lost profits or loss or damage to data arising out of the use or inability to use this document.

Contents

Packing List	1
Getting Know Your System	2~3
Hub	2
Description of Indicator Lights	3
How to identify if the system is working through WiFi or Cellular?	3
Remote Control	4
Door/Window Contact	5
Tamper Switch	5
Low Battery Indication	5
Pet-Immune PIR Motion Detector	6~7
Tamper Switch	6
Detection Area	6
Pet-Immune Function	7
Working Mode	7
Getting Started	8~11
Step One: Download the App	8
Step Two: Sign Up/ In	8
Step Three: Add the Smart Hub to the App	9~11
Device Control and Settings	11~19
System Status	12
Edit Accessories	12
Zone Mode	13
Add New Accessories to the Hub	14
Settings	15~19
App Operation	20~23
Remote Phone Operation	24
Installation	25~28
Hub	25
Door/Window Sensor	26
PIR Motion Detector	27~28
Replacing Accessory Batteries	29
Restoring to Factory Settings	29
Specifications	30~31

Packing List



Smart Hub x1

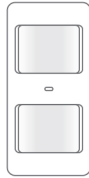

PIR-910 Pet-immune PIR Motion Detector x1



DWC-102 Door/Window Contact x2



RC-80 Remote Control x2



Power Adapter x1



Hub Bracket x1

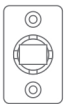

PIR Motion Detector Bracket x1



Double-sided Tape for Door/Window Sensor x4



Quick Guide

Getting to Know Your System

Hub

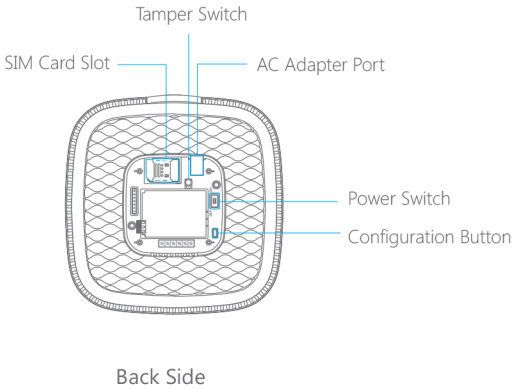
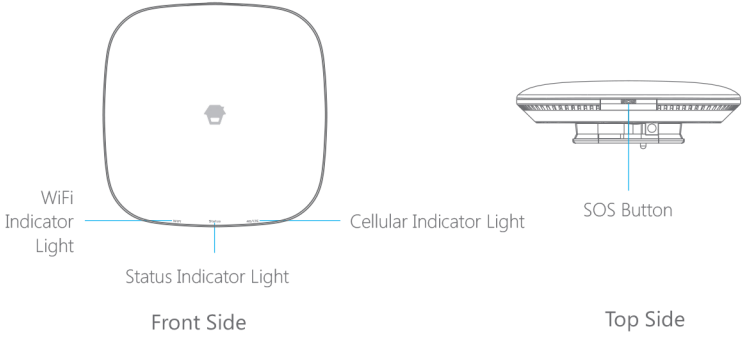

Description of Indicator Lights

Indicator Light	Status	Meaning
Wi-Fi Indicator Light	Blinking	Searching for Wi-Fi network
	Solid Yellow	Booting up after power on or Cellular network is connected, but the system is using the WiFi network.
Status Light	White	Powered on
	Blinking White	Hub is in low battery condition. Please connect with AC power.
	Blue	Home mode
	Green	Disarm mode
	Red	Arm mode
	Blinking Red	Alarm/panic mode
	Alternating Red and Blue	The hub is in AP Mode or SIM Card Config Mode.
	Alternating Red, Green and Blue	The hub is in Accessory Pairing Mode.
	Off	Hub is not powered on, or not powered with the adapter.
	Off	No SIM card or Cellular has been deactivated on the App
Cellular Indicator Light	Blinking (3 times per second)	Cellular network is connected and the system is using the Cellular network.
	Blinking (once per second)	Searching for the Cellular network
	Off	No SIM card or Cellular has not been activated on the App.

Note: The hub must be always being connected to AC power in order to maintain a WiFi connection. When AC power is lost, the speaker will beep for 30 seconds and the Hub will stay online for 2 minutes; long enough to send out push notifications to users alerting them of the power disconnection. The system will remain active and continue to monitor during a power outage. If the system is armed, it will activate its onsite alarm if a sensor is triggered.

How to identify if the system is working through WiFi or Cellular?



Working through WiFi: The WiFi indicator is steady on.

Working through Cellular: The WiFi indicator and the Cellular indicator blink quickly.

Remote Control

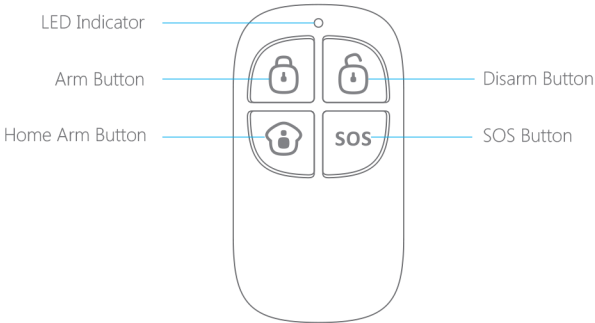
The remote control can be used to Arm, Home Arm and Disarm the system. It can also be used to trigger an emergency alarm (SOS) manually.



Button	System Status
	All sensors will be Armed. Set to this mode when the property is unoccupied.
	The system will be Disarmed, no sensor will trigger the alarm. Note: When system is set to 'Disarm', all fire, smoke and water sensors (purchased separately) will remain active as they are factory set to 24-Hour Zone.
	Sets the system to Home mode. Sensors that are set to the Home Zone will not be Armed while all the others will be Armed. This mode allows a select set of sensors (Sensor in Arm Zone and 24-Hour Zone, for example, door/ window contacts) to be Armed, allowing the occupier freedom of movement within the property.
SOS	The SOS button will trigger the alarm and send an alert notification to registered users regardless of the hub mode.

Door/Window Contact

Door/window contacts are set to 'Armed' zone by default and are ideal for protecting entry/exit points such as front doors, back doors, and windows. When the system is Armed (Away Mode) and the door/window contact is triggered (magnet separated from the transmitter), the hub internal siren will sound immediately and send a push notification with the sensor name to its registered users.

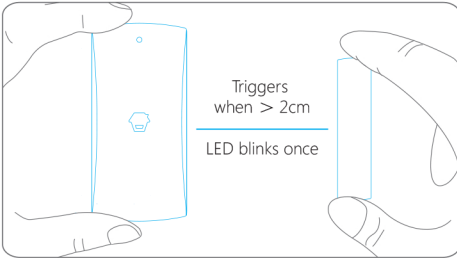

Tamper Switch

The tamper switch (small black button underneath the back cover) will activate the alarm if an unauthorized attempt is made to remove the contact from its installed location.

Low Battery Indication

If the LED indicator flashes once per 3 seconds, the battery must be replaced.

Pet-Immune PIR Motion Detector

The motion detector is designed for use on interior walls and is set to Home Mode by default. Whenever the sensor detects movement (only while the alarm is armed), a push notification including the sensor name will automatically be sent to the registered users, and the hub's internal siren will sound immediately.

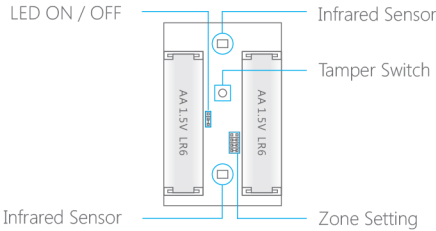
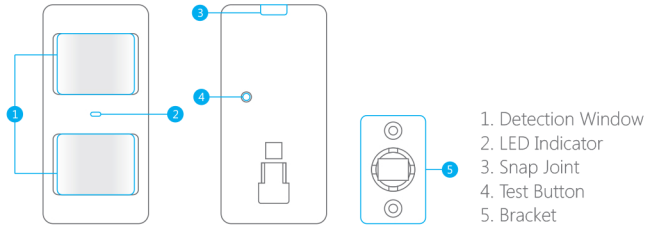

Blinks continuously	Motion detector is performing a self-test
Blinks once	Motion detected
Blinks once every 3 seconds	Low battery indication, please change the battery immediately

Tamper Switch

The tamper switch will trigger an alarm notification if an unauthorized attempt is made to remove the cover of the detector from its housing.

Detection Area

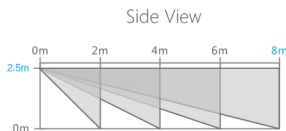
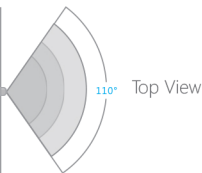

Pet-Immune Function

This sensor adopts dual detection window design to improve detection accuracy. It was only when both detection windows detect body movement will it trigger an alarm. While only one window will not cause an alarm. Based on this principle, pets less than 25 kg will not be detected by the sensor.

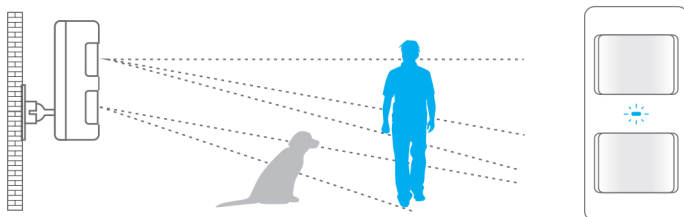

Working Mode

Testing Mode

Press the test button, the detector enters testing mode and detects once every 10 seconds. After 3 minutes, the LED indicator blinks twice, and the detector switches to power saving mode.

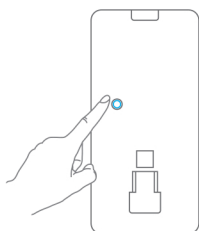

Power Saving Mode

This motion detector has smart power saving function. If the detector is triggered twice within 3 minutes, it enters sleeping state immediately to save power. During this period, any movement detected does not generate an alarm. After no movement within the next 3 minutes, it goes back to working state again.

Note: When the detector goes into sleeping state, the precondition of alarm is that no one moves in 3 minutes in the detection area; otherwise it will remain in the sleeping state. If the detector is in sleeping state, it is suggested to leave the room and make sure nobody moves in the detection area. The detector will go back to working state in 3 minutes.

Getting Started

Step One: Download the App

Download the app from the App Store or Google Play by searching the keywords "DreamCatcher Life".



Step Two: Sign Up/ In

Press the "Sign up" button on the page and follow the instructions to create your account first.

Once you have an account, select the "Sign in" to enter the login page.

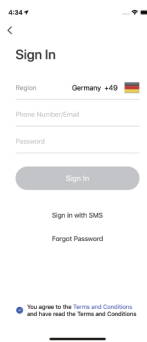
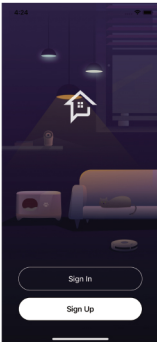

Step Three: Add the Smart Hub to the App

1. Press the [+] button on the main page. Tap on [Security & Sensor], then follow the device set up steps to connect the hub with your home WiFi.

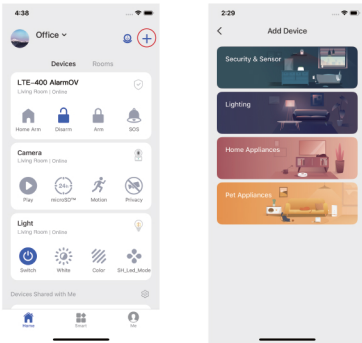

2. There are two ways to add the device: AP Mode and SIM Card Config.

AP Mode: Press the configuration button for 5 times and you will hear one beep, then enter the Wi-Fi password and tap "Confirm". Next, connect your mobile phone to the device's hotspot. In your phone's Wi-Fi list, connect to "LTE-400 Alarm" and then return to the app, wait for the connecting process to complete.

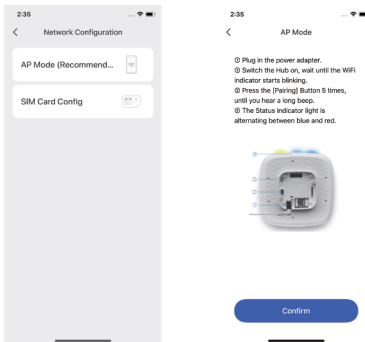

Important: The Hub does not support 5GHz band Wi-Fi. If a dual-band (5GHz and 2.4GHz) router is used, make sure to connect to the 2.4GHz Wi-Fi instead of the 5GHz's. Make sure your smart phone is connected to the local Wi-Fi network and then follow the steps in the app to connect the hub to the router.

SIM Card Config: If home Wi-Fi is not available, SIM card Config comes in handy for sending notifications, SMS. First prepare a regular-size 4G SIM card and insert it into the hub's SIM slot.



Press the configuration button for 5 times and you will hear one beep, and then connect your mobile phone to the device's hotspot. In your phone's Wi-Fi list, connect to "LTE-400 Alarm" and then return to the app, wait for the connecting process to complete.

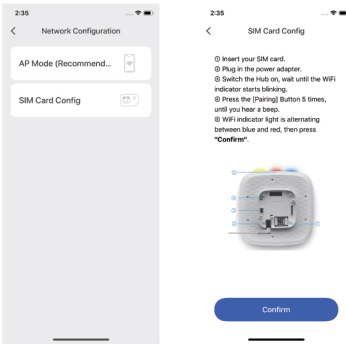

If the SIM card config fails, you might need to fill in the APN settings of the card.

***Note:** The APN setting varies from country to country. Please consult the local operator on how to set the APN correctly.

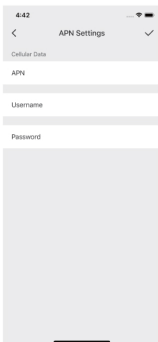

Note: If you intend to use Cellular as a backup in case of Wi-Fi disconnection, please insert the SIM card and go to LTE-400 Settings --Advanced Settings -- first enable Cellular Network and input required information for cellular data in APN Settings. Set up SMS notification can be found here as well, input the number which you'd like to receive SMS and click the SMS icon respectively.

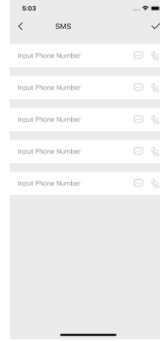
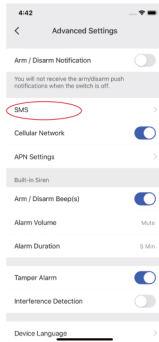
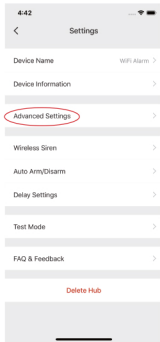

Device Control and Settings

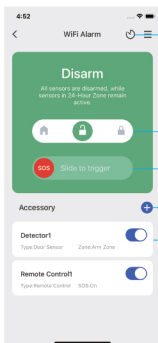

History & Setting

System Status: Home Arm, Disarm, Arm

SOS Alarm

Tap to add new accessories

Accessory Status

System Status

Arm

All sensors will detect for anomalies during this mode. The hub internal siren will sound immediately when a sensor is triggered. You and other pre-authorized users will receive push notifications on your phones.

This mode is suitable when the property is unoccupied. It can be set from the remote control or app.

Home (Part Arm)

All Home Zone sensors will stop detecting during this mode. This allows you and your family to move freely inside your home without triggering an unwanted alarm.

Note: The door/window sensors in this kit have been set to Arm Zone and the PIR sensor is set to Home Zone by default, you can change their zone mode on the "Accessory" section of the App.

This mode is recommended for when someone is at home. It can be set from the remote control or app.

Disarm

All sensors stop detecting except 24-Hour Zone sensors, which will trigger the alarm regardless of system status.

Edit Accessories

Tap the accessory to enter its setting page where you can rename the device or set the device type and zone mode.

Tap the switch to disable the accessory.

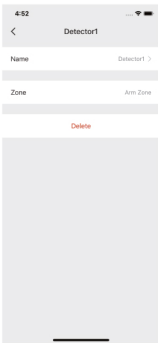

Zone Mode

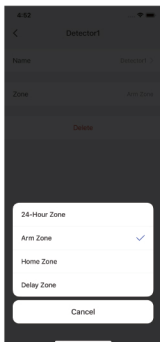

Arm Zone

Sensors set to Arm Zone are armed when the system is in Away (Full Arm) or Home Arm (Part Arm) status. We recommend setting window/door sensors to this zone as they usually secure the perimeter of the house.

Home Zone

Sensors set to Home Zone are only armed when the system is in Away (Full Arm) status. During Home Arm mode, these sensors will not be armed and will not activate the alarm when triggered. We recommend setting PIR motion sensors to this zone as they usually secure the interior of the house.

24-Hour Zone

Sensors set to 24-Hour Zone will activate the alarm when triggered, regardless of the alarm status at the time (away or disarmed).

Delay Zone

The working mode of sensor in this zone will be same as Arm Zone sensor's, but the Hub will alarm after an Entry Delay Time* if this sensor is triggered when system was armed or in home mode.

* Entry Delay Time: you can set this delay time on LTE-400[Settings]-[Delay Settings]-[Entry Delay].

Note: Optional Smoke, Gas Leakage or Water Flood Sensors are automatically registered as 24-Hour Zone sensors and cannot be changed to other Zones. Any motion or door/window sensors paired to the hub by the tamper switch will be registered as an 24-Hour sensor.

Add New Accessories to the Hub

Remote control, Door sensor and other accessories.

Enter the LTE-400 Smart Hub home page and tap "+" beside accessory, then trigger the accessory to add it to the hub.

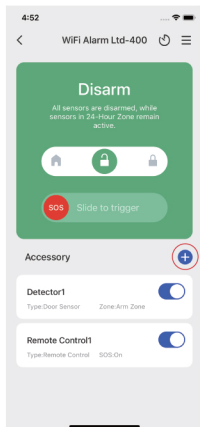

Pair with Remote Control

Press any button on the remote control

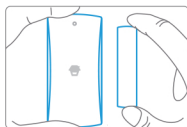

Pair with Door Sensor

Separate the transmitter from the magnet

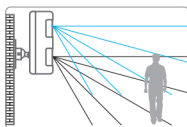

Pair with PIR Sensor

Place the PIR motion detector in a high position and then walk within the detection area to trigger the PIR alarm once (the indicator light flashes once).

Please note that pressing the tamper switch instead of triggering the sensor will register it as an 24-Hour Zone sensor.

(Optional Accessory) Wireless Siren

1. Press the Learn Button on the Siren
2. Arm the Hub via the App

Settings

Tap [] button to enter into hub setting page.

Device Name

This setting enables you to rename your hub, and the new name will be shown on the Home Page.

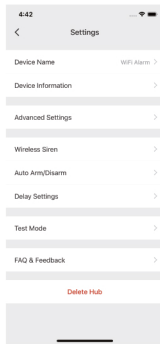
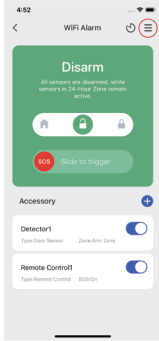

Device Information

Check detailed information of the hub and update firmware if needed.



Wireless Outdoor Siren

When connecting an Outdoor Siren (optional accessory) to the Hub, you can enable the arm/disarm alert sound of the siren on the app.

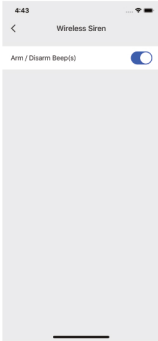

Auto Arm/Disarm

The system can be programmed to automatically Arm and Disarm the system at predefined times by following the steps below:

1. Enable a timer to add a scheduled action.
2. Choose any mode you want the system to become (Away / Disarm / Home).
3. Choose the activate time of the status.
4. Select the date that you want this timer to repeat.

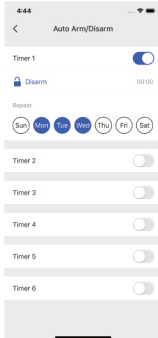

Delay Settings

Exit Delay Time

Set a time delay for you to leave your property without triggering an alarm. You can choose to switch on the delay alert sound.

Entry Delay Time (Available only for Delay Zone Sensor)

Set a time delay for you to enter your property without triggering an alarm. You can choose to switch on the delay alert sound.

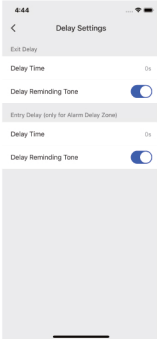

Test Mode

Under test mode, if you trigger any sensors, the system will not sound the alarm but give out 3 beeps. You can quit this mode once you finish the testing.

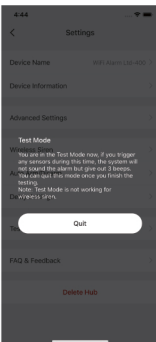

Advanced Settings

Here you can find general settings of the hub, like enabling arm/disarm notification/sounds, adjusting internal siren's volume level, alarm duration, switching on interference detection and changing Wi-Fi network of the hub.

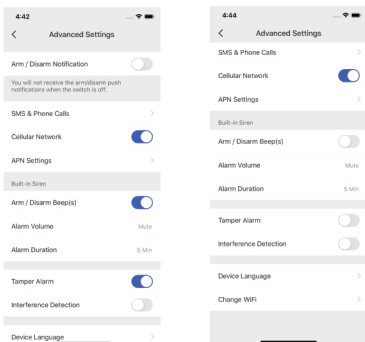

Delete Device

Click to delete the device, and the sharing settings that have been set will also be deleted.

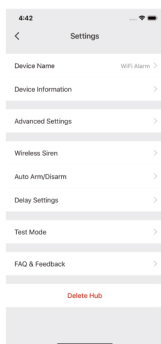

History

Operations and alerts can be reviewed from this history page. Tap on the [🕒] to access the history page. You can tap on the [📅] at the top left corner and select a specific day to search for an alert.

Only the most recent 300 alerts will be shown. New alerts will overwrite the oldest ones.

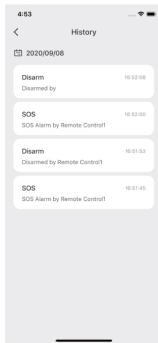
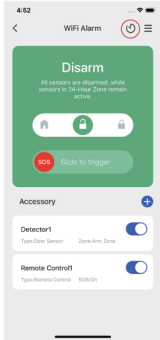

App Operation

Main Page

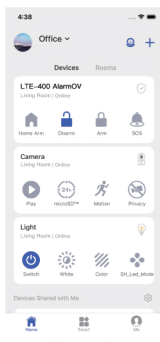

Devices

There are four shortcut actions right below the hub online status: Home Arm, Disarm, Arm and SOS.

Rooms

If you have created rooms for your home, rooms will be listed here. Check for more information on [Me]-[Home Management]-[My Home]-[Room Management]. You can assign the hub to the room you'd like (for example Living Room), then the hub will be shown under [Rooms]-[Living Room] as well.

Account Management

Tap the portrait on the main page to enter the account management, where you can change your profile photo, add nickname and check your account and security related items like changing sign-in password and delete your account.

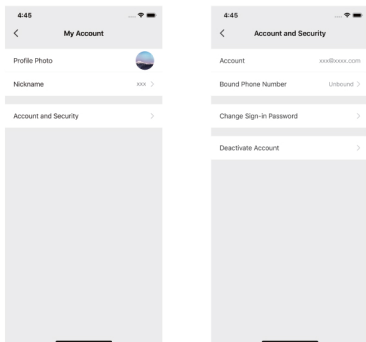

Home Management

Tap [Me] on the main page and tap [Home Management] to add home name, home location, add room(s) to your home and add member to your home.

There are two memberships of users.

Administer (Full Access)

The accounts who are set as administrators cannot delete and transfer the home.

User (Read Only)

The accounts who are set as users can edit the name of the device(s) and receive alerts; re-sharing the device(s) to other users or changing the settings are not permitted.

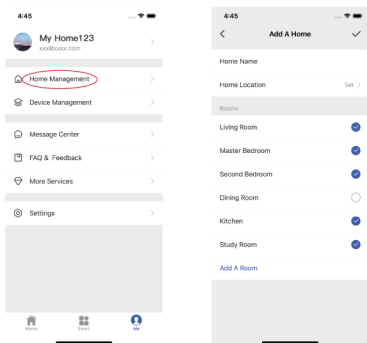

SMS Notification

If there is a SIM card inserted into the hub. The stored phone numbers (up to 5 numbers) will receive SMS in case of triggered alarms.

Note: More details about remote phone control, please refer to page 24

Device Management

You can check all the devices under the same account, including devices of your own and those shared from other accounts.

You can share individual device to others without adding them to your home. Tap the device then tap [+] to share it to other registered accounts. You can also delete the shared account if you don't want people to have continuous access to the device you shared.

The account who receives the shared device(s) is of user access of the device.

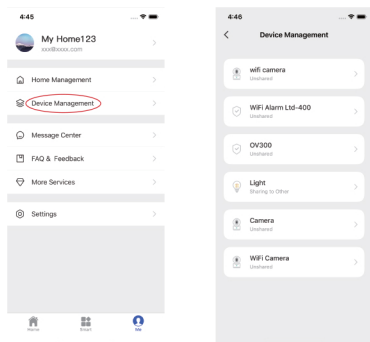

Message Center

Alerts

Here you can check hub's arm/disarm and triggered events.

Bulletins

Here you can check all system notifications, like firmware update, device sharing invitation etc.

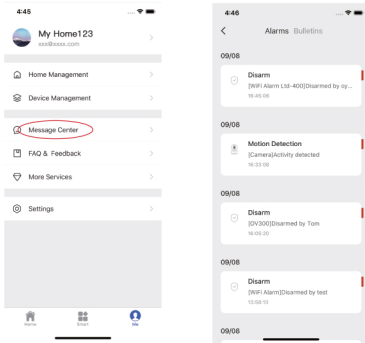

FAQ & Feedback

Tap to find questions and answers to the products and application. Feel free to send us feedback on the product or the service.

Settings

App Notification

App notification includes alert and bulletin information, you can enable push notification or of bulletins all together or individual devices.

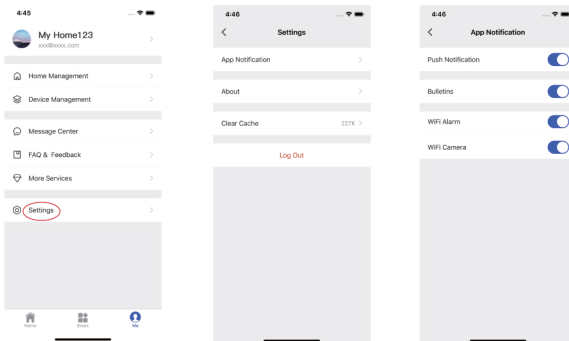

Remote Phone Operation

User can store phone number in App [Setting]-[Advance Settings]-[SMS notification].

The hub sends SMS message the stored numbers in case of alarm, the system is in a 1-minute-monitoring state, the user is able to press the number keys on the smart phone to control the system remotely.

Note: Phone numbers which have not been authorized by the hub are unable to control the system.

Keypad Commands

Phone Button	Function
0	Disarm
1	Arm
3	Listen in
#	Hang Up
6	Turn Off Siren
9	Turn On Siren
*	Two-Way Talk

Note: In case of emergency, app alert notifications will be sent firstly, and then SMS will follow immediately.

Installation

Hub

For the best signal, we recommend that you place the hub in an open, centrally located area. Avoid placing the hub on the ground, a load-bearing wall or beside electrical appliances.

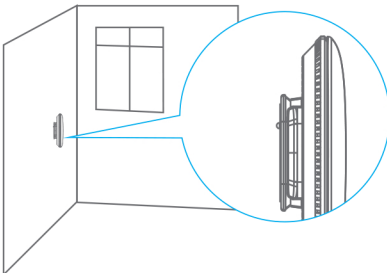
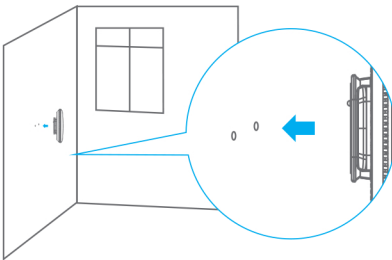

Door/ Window Contact :

Step 1: To power up the contact, remove the battery tab.



Step 2: Attach the adhesive pads to the back of the transmitter and magnet.

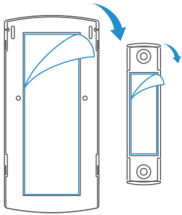

Step 3: Place the contact on the door/window frame and the magnet on the door/window ensuring that the distance between them is not greater than 1cm when the door/window is shut.

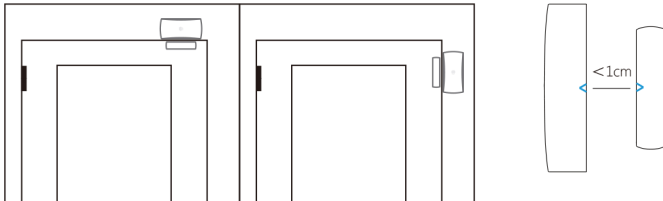

PIR Motion Detector

Avoid installing the motion detector facing windows, near air conditioning, heating, kitchen appliances, direct sunlight, in another motion detectors detection range, or areas with major temperature fluctuations.

Step 1: Choose a suitable location. It is recommended to install the detector between 2-2.2m (roughly 6 1/2 to 7 1/2 ft.) high from the ground.

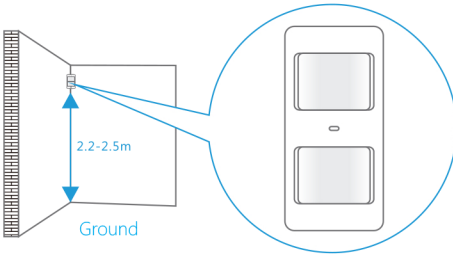

Step 2: Mount the detector on a wall by installing the wall mount with the included screws and attach the detector.

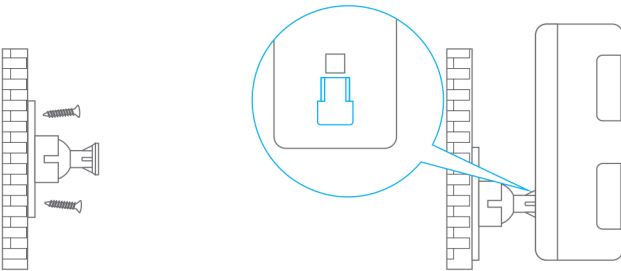

Step 3: To test the detector press the test button on the back. It will enter and remain in testing mode (detect once every 10 seconds) for 3 minutes. Walk into the view of the detector and look for a red light. The LED indicator will blink when movement is detected.

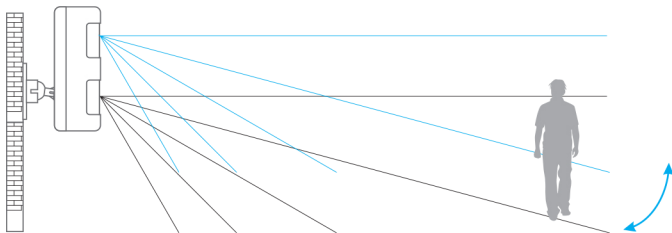

Step 4: Adjust the angle of your unit.



Note: If pet-immune function is applied, please do not adjust the angle up or down, but keep it parallel with the wall.

Replacing Accessory Batteries

Remote Control

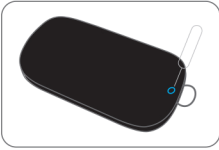

Remove the screw

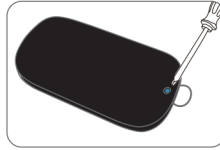

Open the casing

Door/Window Contact

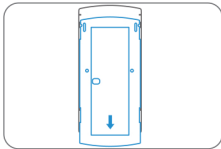

Press down the back cover to slide it open and replace the battery

Pet-Immune PIR Motion Detector



Press down the snap joint

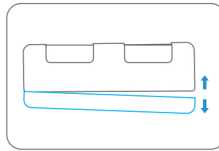

Open the case and replace the battery

Restoring to Factory Settings

Press the Network Configuration button underneath the hub for 10 seconds, hearing one beep at the 5th second then two beeps at the 10th second, which indicate the operation is complete. Release the button and the hub will automatically restart afterwards.

Note: Previously paired accessories will remain connected to your hub after a restore.

Specifications

Hub

Power Supply	5-12Vdc 6W
Battery	3.7V 2200mAh 18650 Rechargeable Lithium Battery
WiFi	IEEE 802.11b/g/n
Cellular	LTE Bands: B1/B3/B5/B7/B8/B20 GSM: B3/B8
Standby Current	< 350 mA
Alarm Current	< 650 mA
Internal Siren	93 dB
Optional Accessories	10 Remote Controls, 50 Sensors
Radio Frequency	315MHz or 433.92MHz
<i>*Europe and Australia: 433.92MHz</i>	
Housing Material	ABS Plastic
Operating Condition	Temperature 0°C~+50°C Relative Humidity <80% (non-condensing)
Hub Dimensions	160 x 160 x 45mm (L x W x H)
Bracket Dimensions	80 x 80 x 10mm (L x W x H)

Remote Control

Power Supply	DC 3V (CR2025 lithium battery x 1pc)
Transmit Current	<7 mA
Transmitting Distance	<80 m (open area/no interference)
Radio Frequency	315MHz or 433.92 MHz
<i>*Europe and Australia: 433.92MHz</i>	
Housing Material	ABS Plastic
Operating Condition	Temperature 0°C~+50°C Relative Humidity <80% (non-condensing)
Dimensions	58 x 31 x 9.5 mm (L x W x H)

Door/ Window Contact

Power Supply	DC 1.5V (1.5V AA LR6 battery x 1pc)
Static Current	<35 uA
Alarm Current	<40 mA
Transmitting Distance	<80 m (open area/no interference)
Radio Frequency	315MHz or 433.92 MHz
<i>*Europe and Australia: 433.92MHz</i>	
Housing Material	ABS Plastic
Operating Condition	Temperature 0°C~+50°C Relative Humidity <80% (non-condensing)
Transmitter Dimensions	71 x 34 x 17.5 mm (L x W x H)
Magnet Dimensions	51 x 12 x 13.5 mm (L x W x H)

PIR Motion Detector

Power Supply	DC 3V (1.5V AA LR6 battery x 2pcs)
Static Current	<18uA
Alarm Current	<12mA
Detection Scope	<8m/110°
Pet Immunity	<25kgs
Transmitting Distance	<80 m (open area/no interference)
Radio Frequency	315MHz or 433.92 MHz
<i>*Europe and Australia: 433.92MHz</i>	
EIRP (dBm) Max.	-7.44
Housing Material	ABS Plastic
Operating Condition	Temperature 0°C~+50°C Relative Humidity <80% (Non-condensing)
Sensor Dimensions	108 x 52 x 36.8mm (L x W x H)
Bracket Dimensions	52 x 30 x 26.5mm (L x W x H)